

<http://www.bomin.com.tw>

BOMIN ELECTRONIC CO., LTD

Metal Button

Automation Components
EJ-M超短款金屬按鈕



EJ-M 超短款金屬按鈕 / Ultra Short Metal Button



■ 特性 / Features

- 安裝直徑12/16/19/22/25mm
- 防護等級：IP67/IP68/IK10
- 彈片：不銹鋼材質
- LED超高亮冷光源燈顯示
- 專用特殊磨砂不銹鋼環，整體
- 超短行程：≤0.5mm

符合IEC60947-5-1 GB14048.5標準
Conform to IEC60947-5-1 GB14048.5 Standard

主要技術參數 / Technical Parameter

保護等級/Degree of Protection	IP67/IP68
觸點類型/Contact Type	1 NO
額定電壓/Rated Voltage	DC36V
額定電流/Rated Current	2A
最小負載/Minimum Applicable Load	3V AC/DC, 1mA
觸點材料/Contact material	Silver plated
運行溫度/Operating Temperature	-25° to +55°C
操作濕度/Operating Humidity	45 to 85% RH
接觸電阻/Contact Resistance	≤50 mΩ
絕緣電阻/Insulation Resistance	≤50 mΩ
震盪電阻/Vibration Resistance	10 to 55Hz, amplitude 1.2mm p-p
保護等級/Degree of Protection	>10g
電氣壽命/Electrical Life	200,000 operations minimum (at full rated load)
機械壽命/Mechanical Life	1,000,000 operations minimum
耐壓/Dielectrical Life	Switch Unit: 2,000V AC, 1 min. between live/dead part and terminals of different poles; 1,000V AC, 1 minute between terminals of the same pole; 1,500V AC, 1 minute between contact and lamp terminals. Illumination Unit: 2,000V AC, 1 min. between live part/ground
連接形式/Connection Form	Foot welding
錫焊溫度/Soldering Temperature	20W/5 seconds or 260°C/3 seconds
擰緊力矩/Tightening Torque	5-14N.m
動作行程/Action Stroke	≤0.5mm
動作力/Action Force	≤3N

尺寸超短、行程超短



按鈕開關型號命名 / Pushbutton Select Code

	—					—		
安裝尺寸 Install Size	動作方式 Action Style:	頭部形狀 Shape of Top:	觸點形式 Contact Type:	安裝方式 Install Style:	顏色/Color:	電壓/Voltage:	材料/Material:	
12mm 16mm 19mm 22mm 25mm	2:自複按鈕 2: Momentary	1: 平頭 7: 環面帶燈 1: Flat Round 7: Ring Illumated	1:1NO	A:螺絲型 Screw Type P:焊線型 PCB Type	紅色 / Red 綠色 / Green 藍色 / Blue 白色 / White 黃色 / Yellow 橘色 / Orange	D:24VDC E:12VDC F:6.3VDC G:3VDC	空:不銹鋼 A:鋁 T:銅鍍鉻 Ni:Stainless steel A: Aluminium T: Copper plated Cr	

注：常規的定制都是不銹鋼外殼，如需銅鍍鉻外殼，請在型號後面加T。
Note : The regular material is Stainless steel, if you want Copper Plated Cr , please add T behind.

燈珠規格 / Lamp Ratings



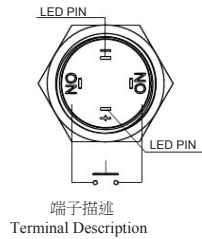
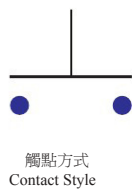

燈珠類型/Lamp Type	LED燈珠(直流) LED lamp(DC)
額定電壓/Rated Voltage	3V,6V,12V,24V
額定電流/Rated Current	約15mA 約2mA About 15mA About 2mA
發光顏色/LED Color	
壽命/Life	50000小時(參考值) 50000 hours(Reference)
燈珠等效電路/Lamp Circuit diagram	<p>內置電阻：採用0603貼片燈珠。 Built in resistors; use 0603 patch beads.</p>
功率/Power	0.06W
顯色指數/Chromogenic index	60-70
光通量/Luminous flux	80-100mcd(lm)
正向電壓/Forward voltage	2.0-3.2V
反向電壓/Reverse voltage	3V
靜電擊穿電壓 (ESD) Electrostatic breakdown voltage	3000V
額定電流/Rated current	0.006A
發光角度/Lighting angle	120°
發光效率/Luminous efficiency	110(lm/W)
熱阻/thermal resistance	≤50°C/W
最大允許結溫 Maximum allowable junction temperature	120°C
老化時間/Ageing time	1000小時常規老化100%；6000小時常規老化98% 1000 hours of conventional aging 100%; 6000 hours conventional aging 98%

觸點示意圖 / Contact Diagram



Ultra short button

EJ-M超短款金屬按鈕/Ultra short metal button

名稱/外觀 Product appearance	帶燈形式 Illuminated type	操作類別 Operation	觸點 Contact	產品型號 Model	外殼材料 Crust Material
平面圓形 / Domed round 	不帶燈 Without LED	自復 Momentary	1NO	EJ12-211PM	空:不銹鋼 A:鋁 G:銅鍍鎳 Nil:Stainless steel A: Aluminium T: Copper plated Cr
平面圓形 / Domed round 	帶燈 With LED	自復 Momentary	1NO	EJ16-211PM	
平面圓形 / Domed round 	帶燈 With LED	自復 Momentary	1NO	EJ19-211PM	
平面圓形 / Domed round 	帶燈 With LED	自復 Momentary	1NO	EJ22-211PM	
平面圓形 / Domed round 	帶燈 With LED	自復 Momentary	1NO	EJ25-211PM	

EJ12-211PM

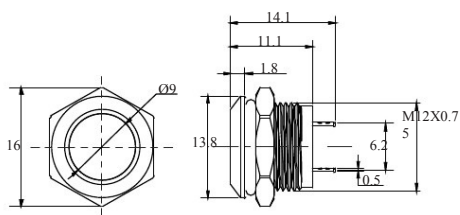
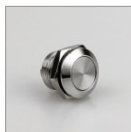

EJ16-211PM

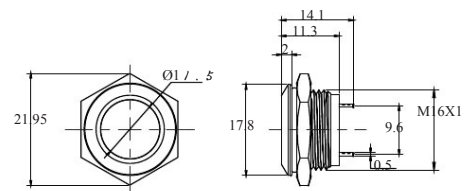

EJ19-211PM

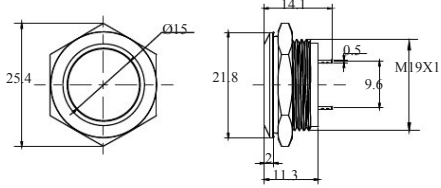

EJ22-211PM

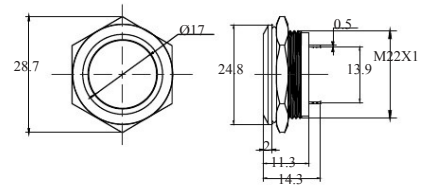

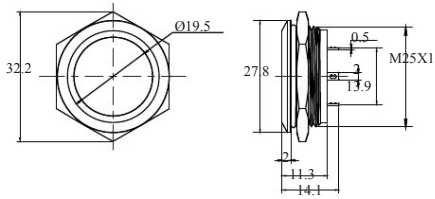

EJ25-211PM



EJ-M超短款帶燈金屬按鈕/Ultra short metal button with lamp

名稱/外觀 Product appearance	安裝形式 Install Style	操作類別 Operation	觸點 Contact	產品型號 Model	顏色 Color	額定電壓 Rated Voltage	外殼材料 Crust Material
 環面帶燈 / Domed round	焊線型 PCB Type	自復 Momentary	INO	EJ12-271PM	請用下列顏色編碼 替換型號中的"□" R 紅色/Red G 綠色/Green Y 黃色/Yellow W 白色/White B 藍色/Blue O 橘色 / Orange	請用下列顏色編碼 替換型號中的"●" D:24VDC E:12VDC F:6.3VDC A1:110VAC A2:220VAC	空:不銹鋼 A:鋁 T:銅鍍鉻 Nil:Stainless steel A: Aluminium T: Copper plated Cr
 環面帶燈 / Domed round	焊線型 PCB Type	自復 Momentary	INO	EJ16-271PM	□●		
 環面帶燈 / Domed round	焊線型 PCB Type	自復 Momentary	INO	EJ19-271PM	□●		
 環面帶燈 / Domed round	螺絲型 Screw Type	自復 Momentary	INO	EJ19-271AM	□●		

Ultra short button

名稱/外觀 Product appearance	安裝形式 Install Style	操作類別 Operation	觸點 Contact	產品型號 Model	顏色 Color	額定電壓 Rated Voltage	外殼材料 Crust Material
 環面帶燈 / Domed round	焊線型 PCB Type	自複 Momentary	1NO	EJ22-271PM	請用下列顏色編碼 替換型號中的"□" R 紅色/Red G 綠色/Green Y 黃色/Yellow W 白色/White B 藍色/Blue O 橘色 / Orange	請用下列顏色編碼 替換型號中的"●" D:24VDC E:12VDC F:6.3VDC A1:110VAC A2:220VAC	空:不銹鋼 A:鋁 T:銅鍍鎳 Nil:Stainless steel A: Aluminium T: Copper plated Cr
 環面帶燈 / Domed round	焊線型 PCB Type	自複 Momentary	1NO	EJ25-271PM	□ ●		

EJ12-271PM

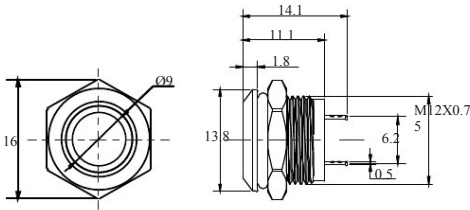

EJ16-271PM

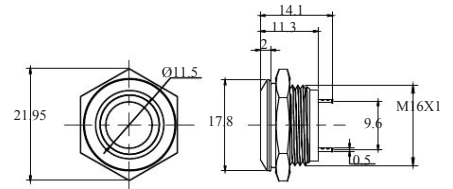

EJ19-271PM

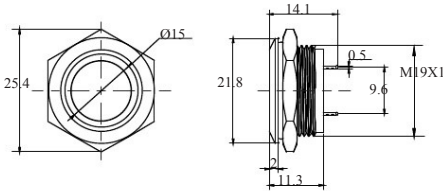

EJ19-271AM

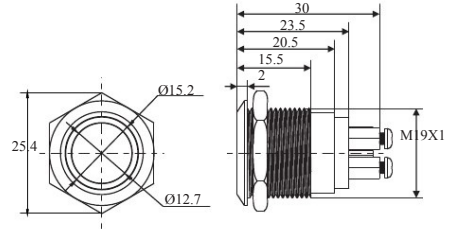

EJ22-271PM

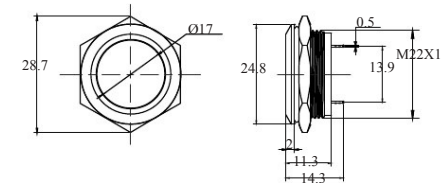

EJ25-271PM

