

# 旋轉開關

# Rotary Switch

<http://www.bomin.com.tw>



## 型號說明 Ordering Information

### RTS-01-206-12FP

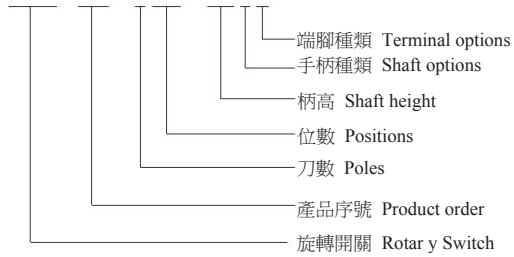

## 技術特性 Specification

- 1.規格 Rating:2.5A 125VAC;1A 250VAC;2.5A 30VDC
- 2.接觸電阻 Contact Resistance:20mΩ max
- 3.絕緣電阻 Insulation Resistance:500VDC 100MΩ min
- 4.耐電壓 Dielectric Strength:1000VAC, 1Minute
- 5.操作溫度 Operating Temperature:-25℃ ~ +85℃
- 6.電氣壽命 Electrical Life:10,000 Cycles

## 電路特性 Circuit y trait

刀數 Poles	位數 Positions
1	00 (12 POS. NO STOPS) , 01, 02, 03, 04, 05, 06, 07, 08, 09, 10, 11, 12
2	00 (6 POS. NO STOPS) , 01, 02, 03, 04, 05, 06
3	00 (4 POS. NO STOPS) , 01, 02, 03, 04
4	00 (3 POS. NO STOPS) , 01, 02, 03

(30° index, Non-shorting contacts)

## 手柄種類 Shaft options

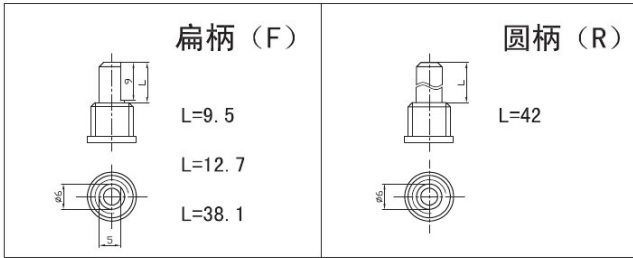

## 端腳種類 Terminal options

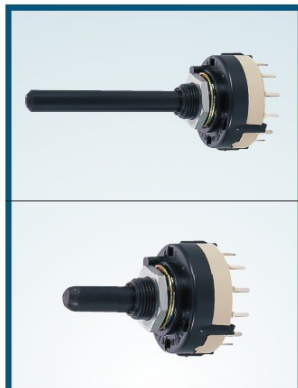
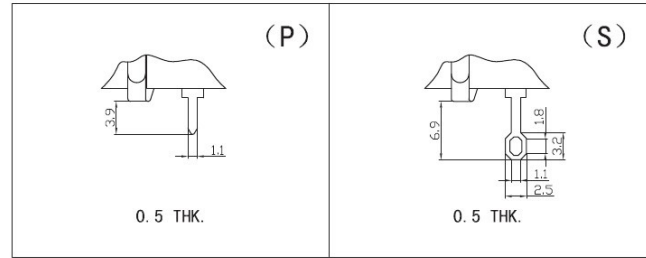

RTS-01-206-42RP

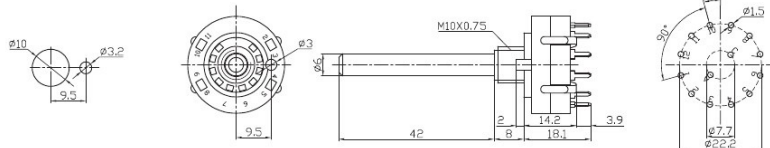

RTS-01-206-9FP

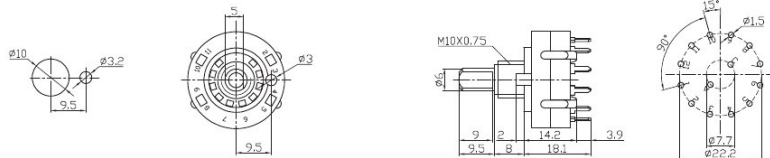

# 旋轉開關

# Rotary Switch



## 型號說明 Ordering Information

### RBS-1-2P6W-20TS

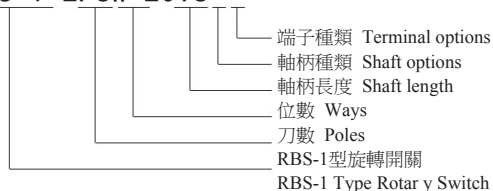

## 技術特性 Specification

- 規格 Rating: 0.5A 125VAC; 0.3A 250VAC
- 刀數 Poles: 1~6
- 位數 Ways: 2~12
- 接觸電阻 Contact Resistance: 20mΩ max
- 絕緣電阻 Insulation Resistance: 500VDC 100MΩ min
- 電氣壽命 Electrical Life: 20,000 Cycles
- 耐電壓 Dielectric Strength: 1000VAC, 1Minute

### 軸柄長度 Shaft length 軸柄種類 Shaft options

L=15
L=20
L=25
L=40

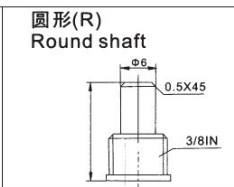
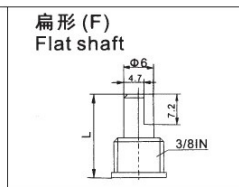
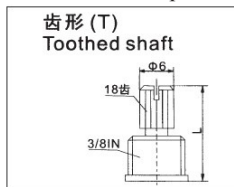

### 端子種類 Terminal options

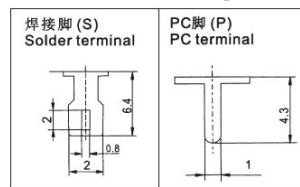

**RBS-1** 2-12 WAYS  
1-6 POLES  
0.5A 125VAC; 0.3A 250VAC

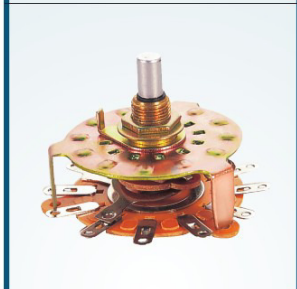
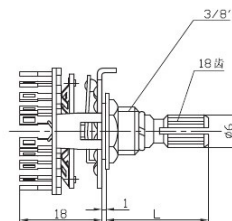
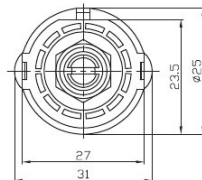
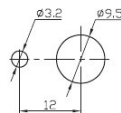

**RBS-2** 11W1P  
5A 125VAC; 3A 250VAC

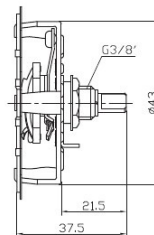
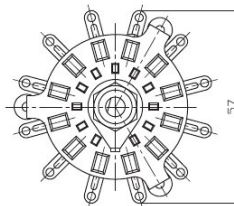
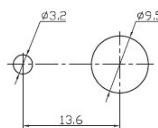

**RBS-3** 11W1P  
10A 125VAC; 5A 250VAC

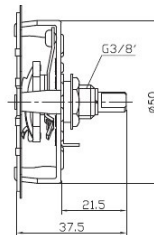
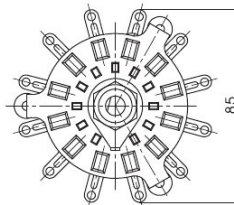
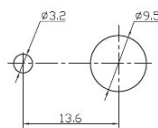

**RBS-4-2P4W**

**RBS-4-2P8W**

10A 125VAC; 6A 250VAC

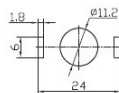

**RBS-4-2P4W**

WAY	A	B	1	2	3	4
0°	○	○				
90°	○		○			
180°	○			○		
270°	○				○	

**RBS-4-2P8W**

WAY	A	B	1	2	3	4
0°	○	○				
45°	○		○			
90°	○			○		
135°	○				○	
180°	○					○
225°	○					
270°	○					
315°	○					

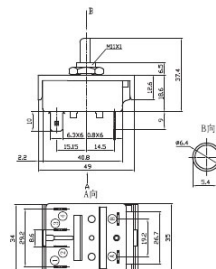

# 旋轉開關

# Rotary Switch



RBS-5-1P4W

3P

RBS-5-1P4W

4P

3A 125VAC; 1A 250VAC

RBS-5-1P4W 3P			
WAY	1	2	3
0°		○	○
90°	○	○	
180°	○	○	○
270°	○		○

RBS-5-1P4W 4P				
WAY	1	2	3	4
0°		○	○	○
90°	○	○	○	
180°	○	○	○	○
270°	○		○	○

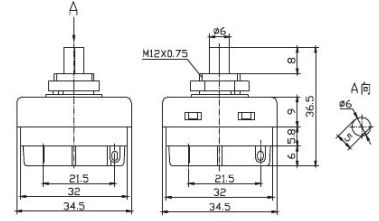

RBS-9-1P4W

6A 250VAC

RBS-9-1P4W				
WAY	L	1	2	3
0°		○	○	○
45°	○	○		
90°	○	○	○	
135°	○		○	○

